

SLOAN[®]

Hand Hygiene Beyond The Restroom
Encourage and celebrate handwashing by making it public





5:41 PM
WELCOME

COVID-19
Update

BUILDING
CHECK-LOCK
STORAGE

Today there is an opportunity to rethink handwashing.

COVID-19 has renewed our attention on the need for increased hygiene in public spaces. As the Pandemic has progressed, the expected outcome has been installing hand sanitizer stations at every turn. These convenient solutions sanitize our hands but rarely leave them feeling clean, filled with an alcohol-chemical mix that often leaves hands sticky and cloaked in an unwanted scent.

Today, there is an opportunity to rethink hand sanitation and return to the fundamentals of soap and water. We can celebrate and encourage handwashing by bringing it out into the open, integrating it with public spaces we engage with throughout our day.





Hand Hygiene for Office Buildings

Sanitizing your hands upon entering office buildings and tenant spaces has become a critical aspect of a post-pandemic environment. Our research and focus groups identified that variety and choice are essential drivers for adapting this new behavior into a long-lasting habit.

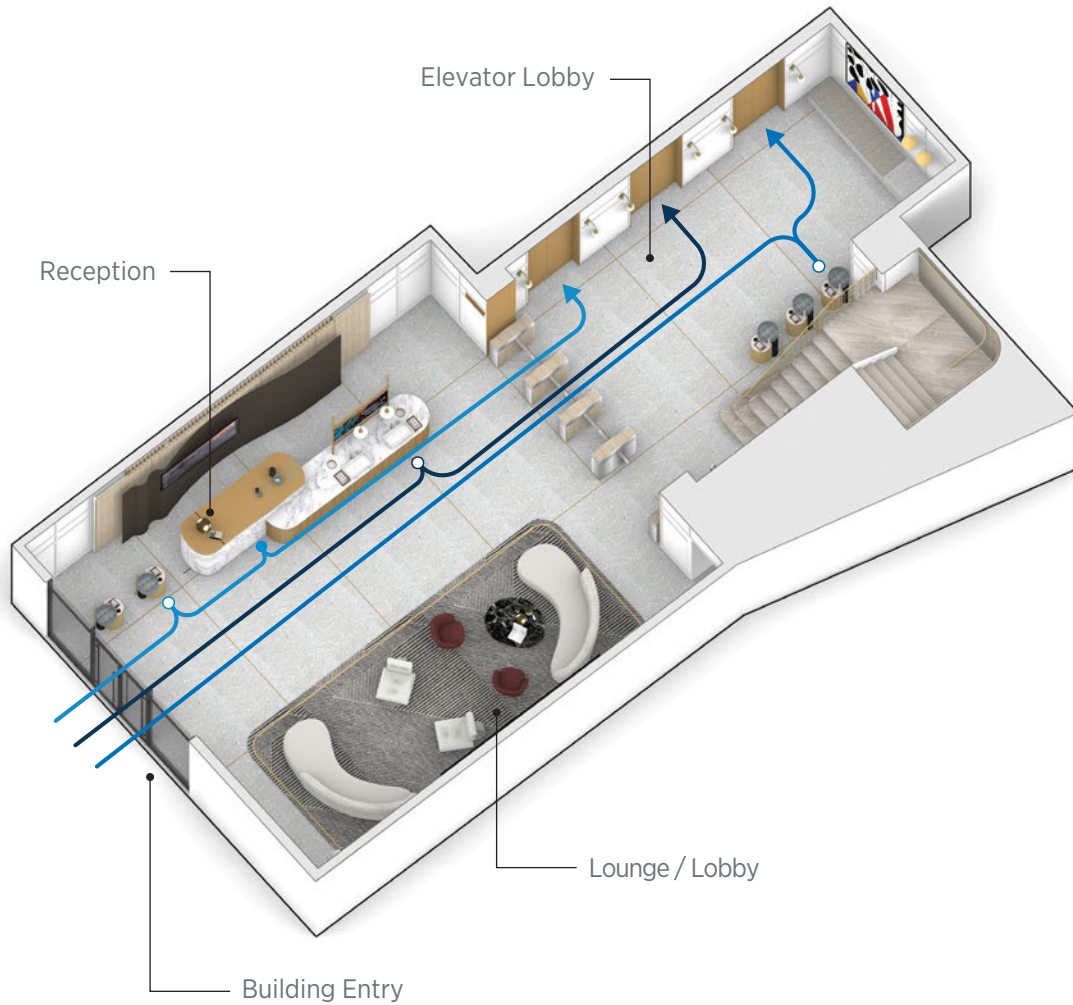

A welcoming office

There are three opportunities along a users' journey in these spaces that can benefit from a range of handwashing options. **The first is directly adjacent to the entry and takes the form of an individual vessel.** These objects create an immediate opportunity to wash hands upon entering the space. The second location integrates with the reception desk and combines handwashing with the chance to absorb informative and educational content. **The third moment is adjacent to the elevators.** These individual vessels are designed primarily for building tenants who are by-passing reception and quickly moving through the space.



Optima 750 Deck-mounted Gooseneck Faucets and Sloan ESD-600 Soap Dispensers





Hand Hygiene for Stadiums

Handwashing throughout the stadium promotes good hygiene in an area where large volumes of people are touching everything and spreading germs.



AER-DEC® Integrated Sink System AD-82000 with custom enclosure

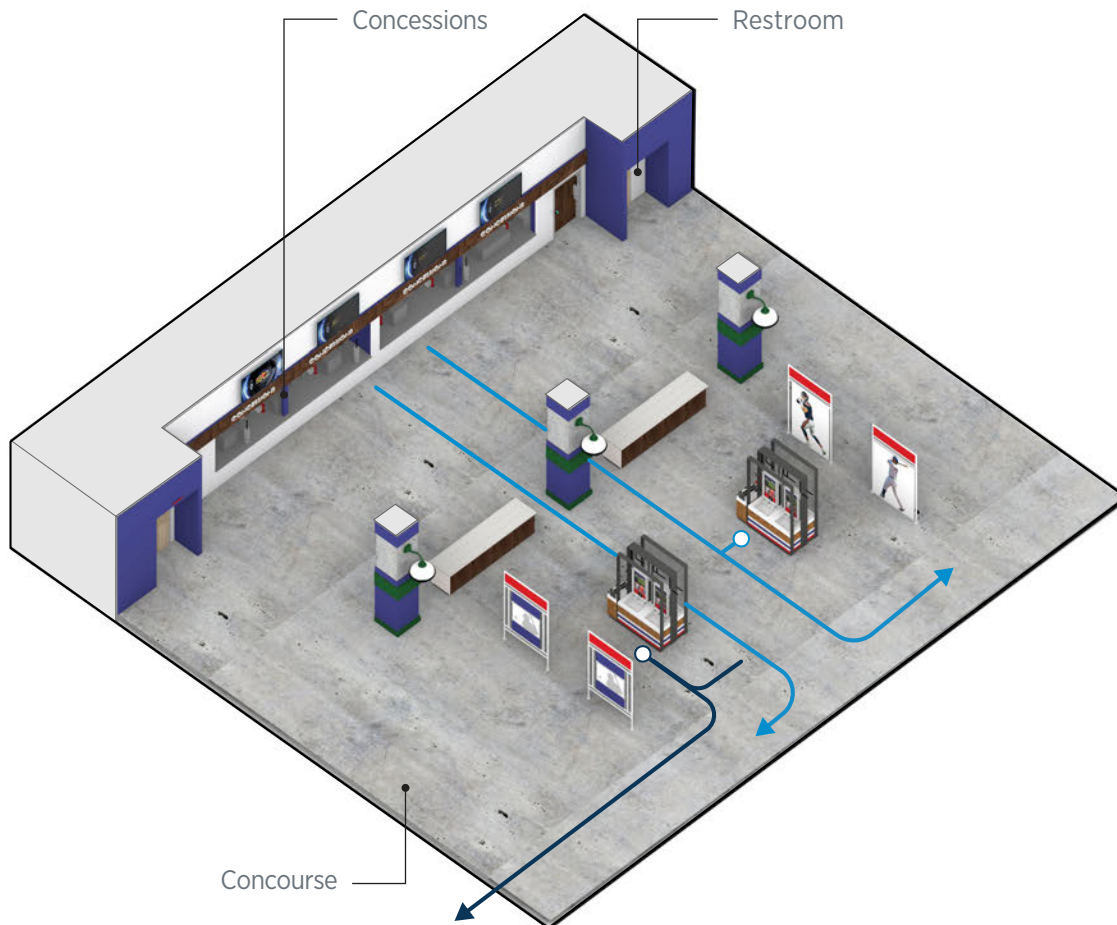

Root for hand hygiene

Adding handwashing basins near concessions and throughout the concourse encourages users to stop and wash their hands without impeding traffic flow. The handwashing stations connect users with an opportunity for good hygiene when arriving or [picking up food and drinks](#).





Hand Hygiene for Airports

Few places are as bustling as an airport concourse. Offering opportunities for handwashing amid this fast-paced environment creates new moments for travelers from across the globe to feel safe and confident.

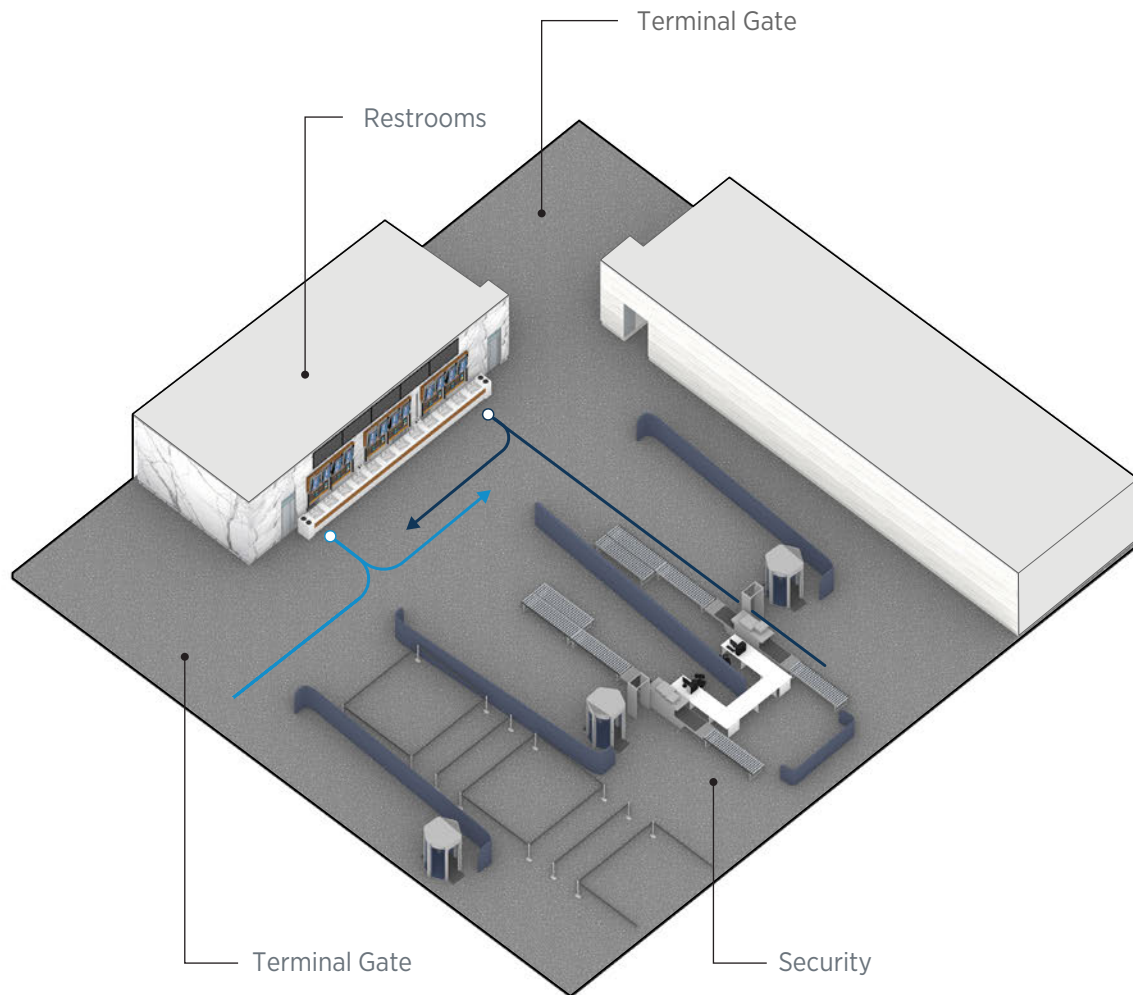

Safe travels

Whether used by a frequent flyer or travelers stopping after security check to wash their hands, these public stations combine handwashing with helpful travel information. [As users move between gates](#), they can quickly get updates on flight arrivals and departures, access digital airport maps, and get quick city highlights in the 20 seconds it takes to wash their hands.



BASYS® EFX-250 Faucets and Sloan® ESD-500 Soap Dispensers on Designer Series™ DSG-86000 6-station Gradient Sink with custom enclosure

"Sing a song, while you wash!"

"Wash longer than 20 seconds and Soapy will appear!"



Happy Birthday to You,
Happy Birthday to You,
Happy Birthday dear...

Sing, Run your feet,
Down the stairs...





Hand Hygiene for Education

The opportunity to bring handwashing outside of the restroom creates a range of fun, engaging, and teachable moments that develop healthy life-long habits.

"Sing a song, while you wash!"

"Wash longer than 20 seconds and Soapy will appear!"



"Happy Birthday to You,
Happy Birthday to You,
Happy Birthday dear..."



"Row, Row, Row your boat,
gently down the stream..."



Optima® ETF-420 Faucet and Sloan® ESD-420 Soap Dispenser on
SloanStone® ELWF-84000 4-station Waterfall Sink with custom enclosure

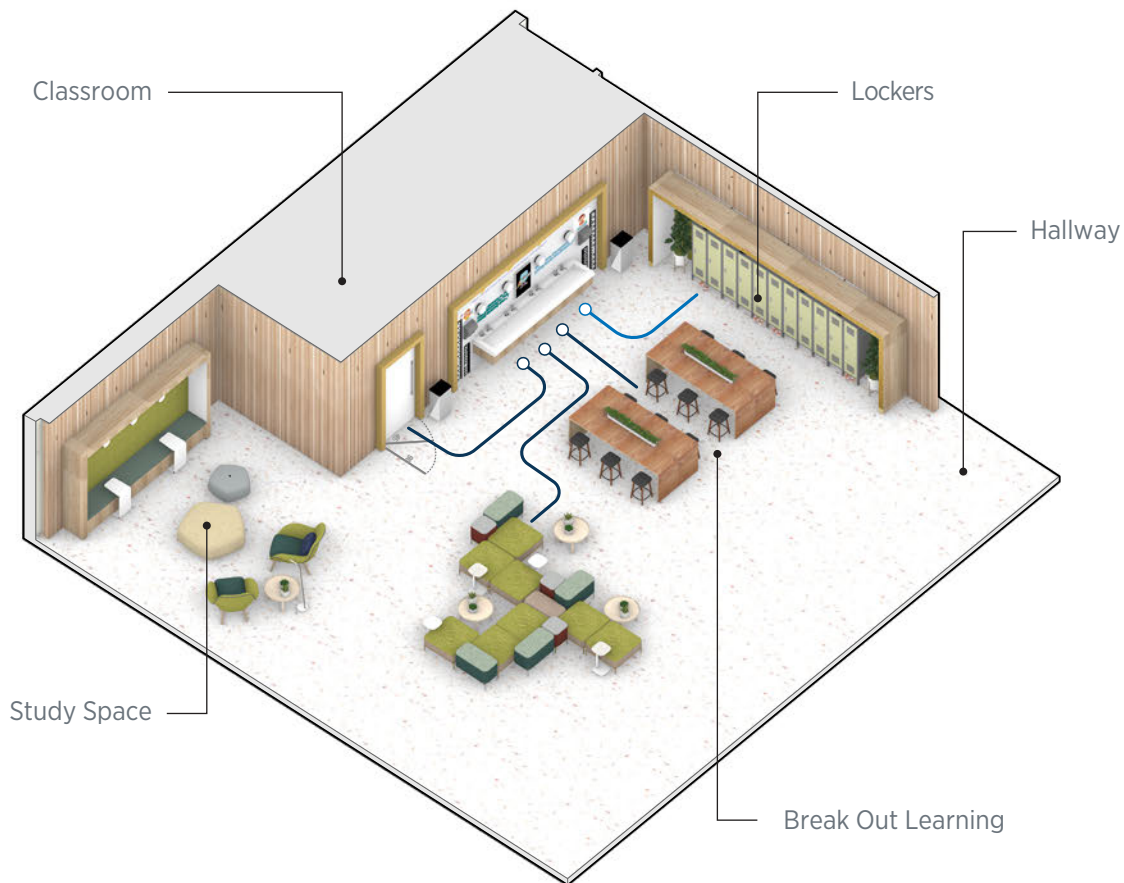

The 1, 2, 3's of handwashing

In addition to high-traffic areas, adding stations along circulation paths, transition points, and break-out areas enhance education spaces with moments for learning good hygiene.

The handwashing station is highlighted in a carved niche with educational visuals in the school break-out area. Easily identifiable from the corridor with fun customizable anecdotal quotes, 20-second song lyrics, plumbing and physics information, and even historical references, this new moment promotes ambient learning and transforms the act of handwashing into an exciting experience.

[Whether students coming directly from lockers before class](#) or transitioning between studying, the addition of these stations in public educational space builds handwashing into student and faculty routines.



A modern, high-end restroom with three oval mirrors, marble sinks, and a portrait on the wall. The scene is set in a well-lit, contemporary space with large windows and a blue wall. The sinks are set on a wooden vanity with a marble countertop. The mirrors are framed in a gold or brass finish. A portrait of a man in a suit is mounted on the blue wall. A potted plant is visible in the foreground on the right.

Hand Hygiene for Retail + Hospitality

Within the retail and hospitality market, experience is everything. As the Pandemic has brought cleanliness to the forefront of users' minds, there is an opportunity to elevate the experience of handwashing through both function and form.



Optima® EBF-815 Wall-mounted Faucets and Sloan® ESD-410 Soap Dispensers
on Designer Series™ DSOF-83000 3-station Open Front Sink with custom enclosure

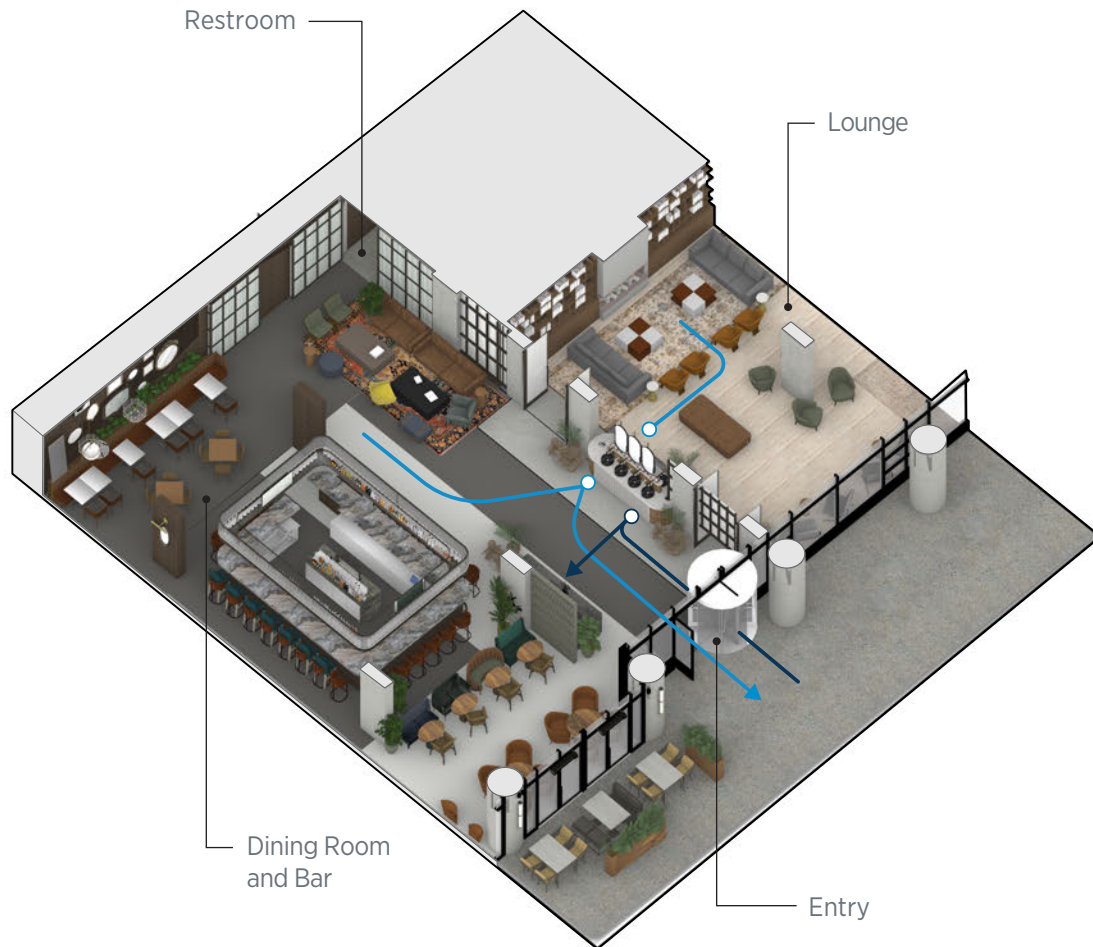

Cheers to health

Focusing on accessibility, aesthetics, and connections, these public handwashing stations are designed to enhance trust and create moments of delight. Bringing handwashing out of the restroom becomes a vital part of the entry sequence and welcomes a new space.

As shown, a double-sided wash station bridges between the entry area and lounge in an example restaurant space. Created to complement the restaurant's design and centrally located to be visually and physically accessible from various rooms, guests can use this handwashing station in multiple ways. From the guests [who check-in and wash their hands while waiting for their table](#) to the lounge patrons who wash their hands before heading to their next destination, this celebrated and convenient moment invites users to participate in a new and meaningful experience.



SLOAN®

Water Connects Us®

World Headquarters

10500 Seymour Avenue
Franklin Park, IL 60131
U.S.A.

800.982.5839
sloan.com

Follow Sloan

[f /sloanvalvecompany](https://www.facebook.com/sloanvalvecompany)

[@sloan_valve](https://twitter.com/sloan_valve)

[@sloan_valve](https://www.instagram.com/sloan_valve)

[p /sloan_valve](https://www.pinterest.com/sloan_valve)

[in /sloan-valve-company](https://www.linkedin.com/company/sloan-valve-company)