

FD81000 FLITE-DEC® Lavatory w/Enclosure

One Station Solid Surface

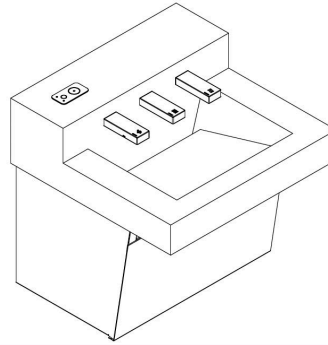

Sink Location

Determine the appropriate wall location for the Lavatory System. Refer to original spec sheets for correct placement of electrical and plumbing locations. If wall is not load bearing, a carrier may be required behind the wall. Refer to the appropriate Rough-In diagram for Lavatory System dimensions. Prior to Lavatory System installation, electric wiring, water supply and drain must be installed.

FLITE-DEC® One Station Components

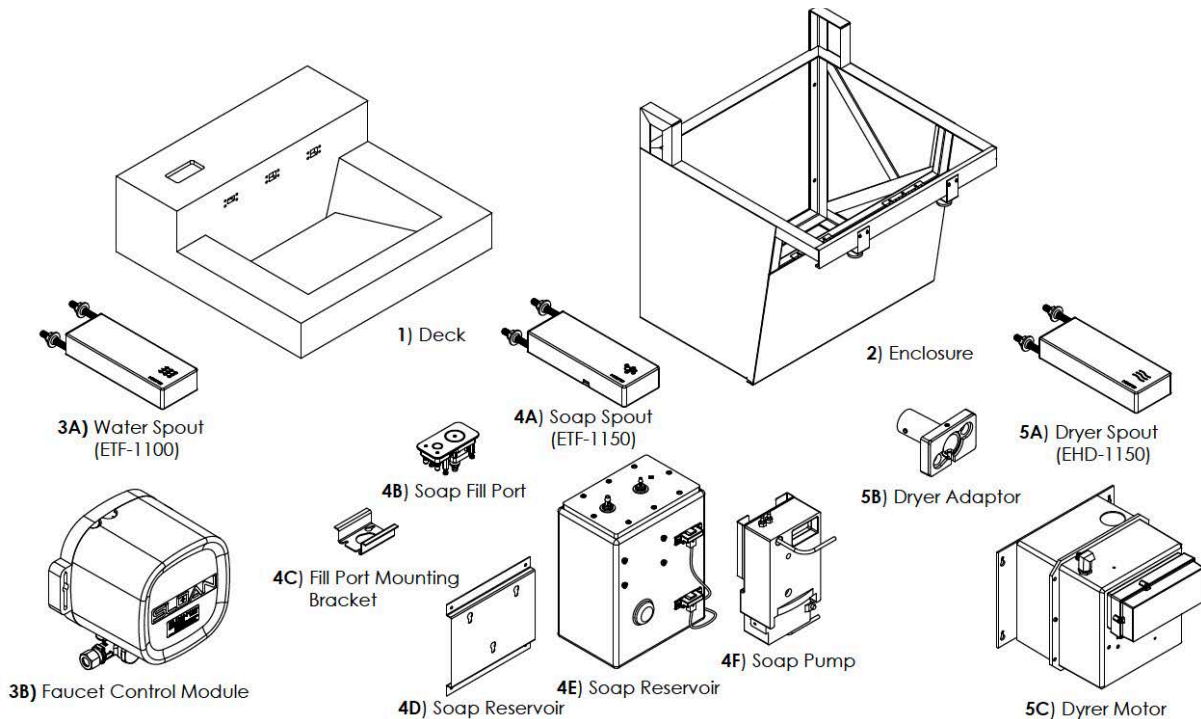

Components List			
Description	Item Number	Quantity	
One Station, Deck	1	1	
Enclosure	2	1	
ETF-1100 Sensor Faucet	3A	1	
Faucet Control Module	3B	1	
ESD-1150 Sensor Soap Dispenser	4A	1	
Soap Fill Port	4B	1	
Fill Port Mounting Bracket	4C	1	
Soap Bracket	4D	1	
Soap Reservoir	4E	1	
Soap Pump	4F	1	
EHD-1150 Dryer Spout	5A	1	
Dryer Adapter	5B	1	
Hand Dryer Motor	5C	1	

FD82000 FLITE-DEC® Lavatory w/Enclosure
Two Station Solid Surface

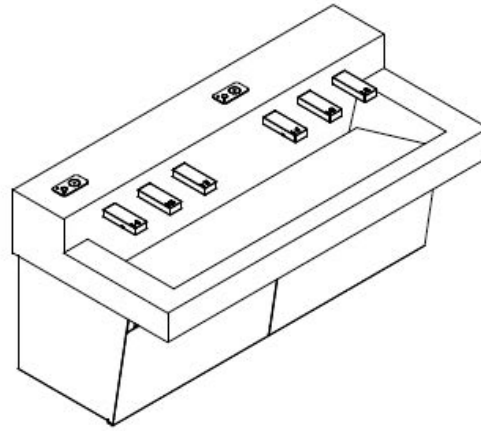

Sink Location

Determine the appropriate wall location for the Lavatory System. Refer to original spec sheets for correct placement of electrical and plumbing locations. If wall is not load bearing, a carrier may be required behind the wall. Refer to the appropriate Rough-In diagram for Lavatory System dimensions. Prior to Lavatory System installation, electric wiring, water supply and drain must be installed.

FLITE-DEC® 2 Station Components

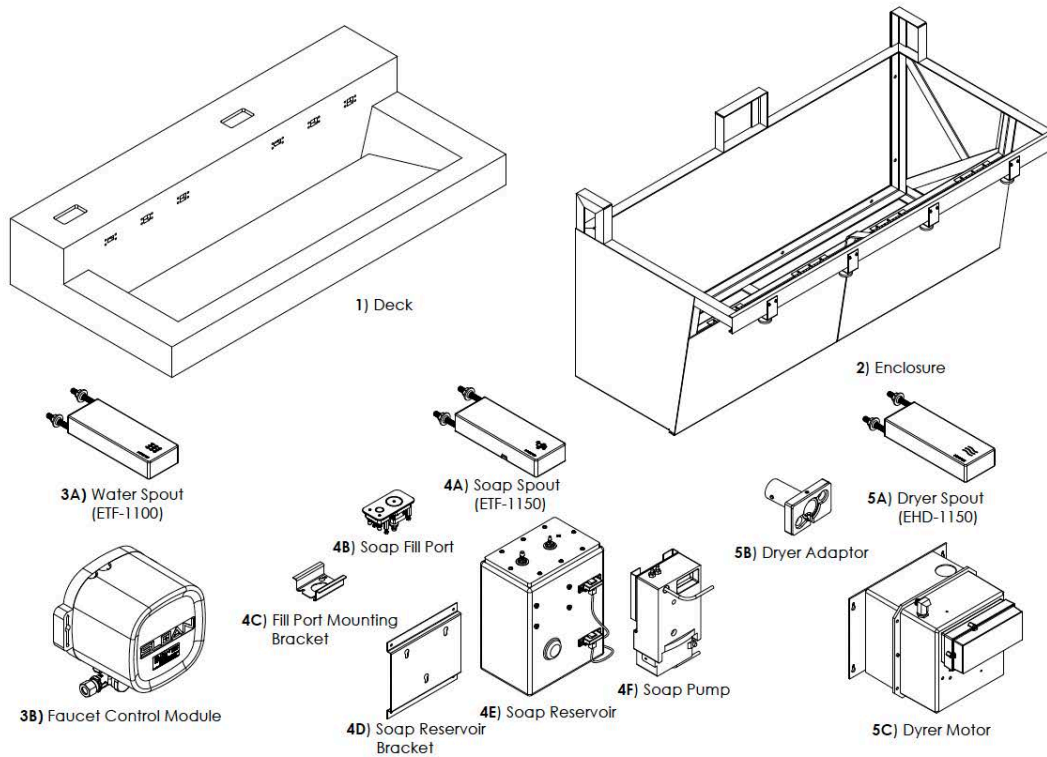

Components List		
Description	Item Number	Quantity
Two Station, Deck	1	1
Enclosure	2	1
ETF-1100 Sensor Faucet	3A	2
Faucet Control Module	3B	2
ESD-1150 Sensor Soap Dispenser	4A	2
Soap Fill Port	4B	2
Fill Port Mounting Bracket	4C	2
Soap Bracket	4D	2
Soap Reservoir	4E	2
Soap Pump	4F	2
EHD-1150 Dryer Spout	5A	2
Dryer Adpapter	5B	2
Hand Dryer Motor	5C	2

FD83000 FLITE-DEC® Lavatory w/Enclosure

Three Station Solid Surface

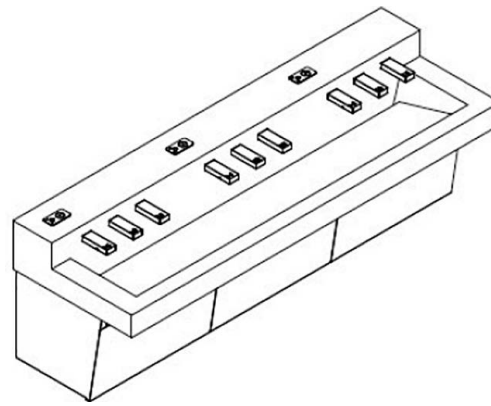

Sink Location

Determine the appropriate wall location for the Lavatory System. Refer to original spec sheets for correct placement of electrical and plumbing locations. If wall is not load bearing, a carrier may be required behind the wall. Refer to the appropriate Rough-In diagram for Lavatory System dimensions. Prior to Lavatory System installation, electric wiring, water supply and drain must be installed.

FLITE-DEC® 3 Station Components

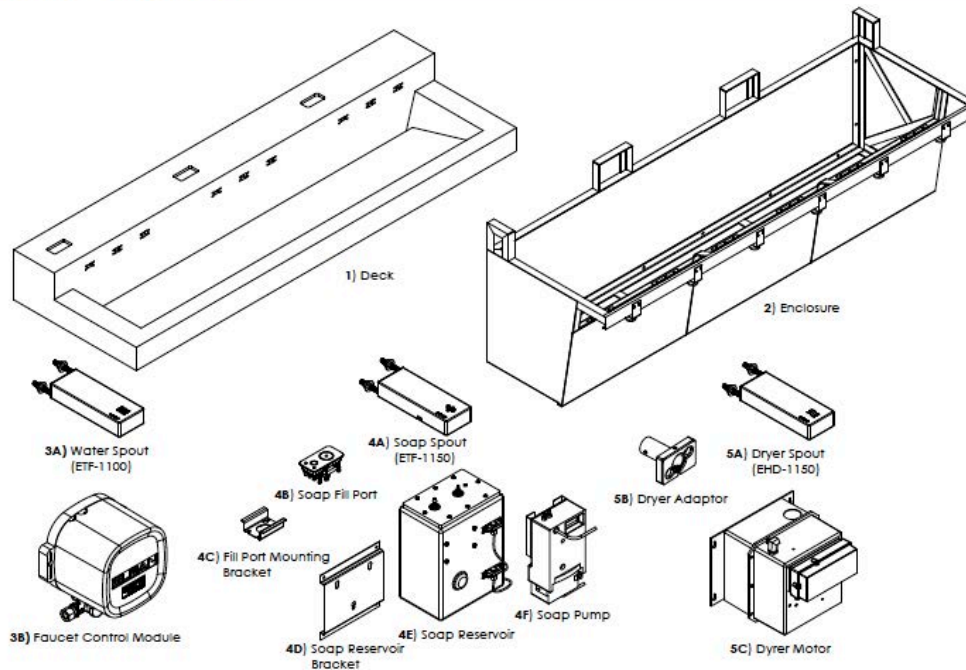

Components List

Description	Item Number	Quantity
Three Station, Deck	1	1
Enclosure	2	1
ETF-1100 Sensor Faucet	3A	3
Faucet Control Module	3B	3
ESD-1150 Sensor Soap Dispenser	4A	3
Soap Fill Port	4B	3
Fill Port Mounting Bracket	4C	3
Soap Bracket	4D	3
Soap Reservoir	4E	3
Soap Pump	4F	3
EHD-1150 Dryer Spout	5A	3
Dryer Bracket	5B	3
Hand Dryer Motor	5C	3

FD84000 FLITE-DEC® Lavatory w/Enclosure

Four Station Solid Surface

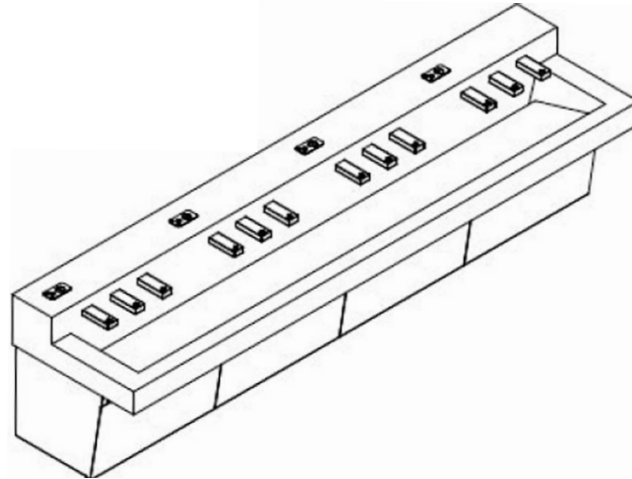

Sink Location

Determine the appropriate wall location for the Lavatory System. Refer to original spec sheets for correct placement of electrical and plumbing locations. If wall is not load bearing, a carrier may be required behind the wall. Refer to the appropriate Rough-In diagram for Lavatory System dimensions. Prior to Lavatory System installation, electric wiring, water supply and drain must be installed.

FLITE-DEC® 4 Station Components

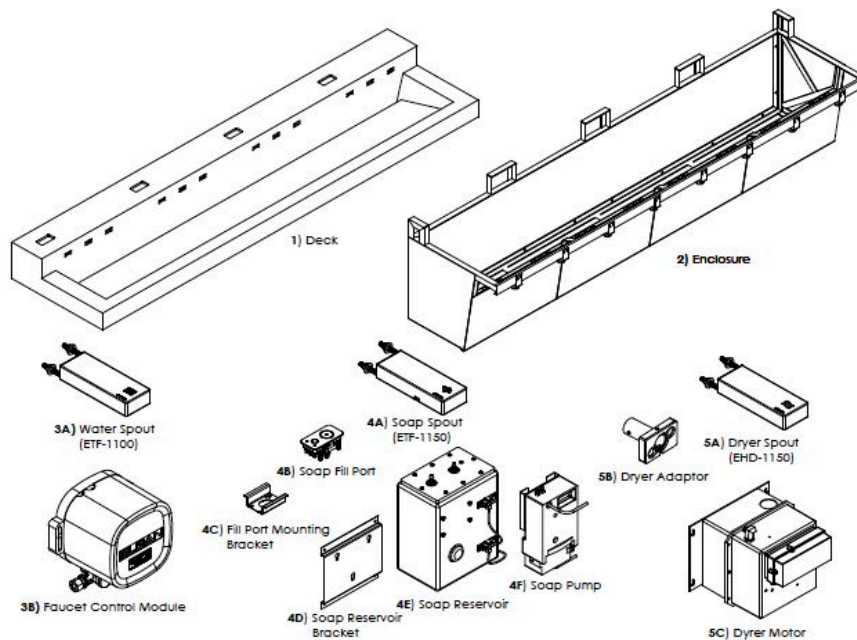

Components List

Description	Item Number	Quantity
Four Station, Deck	1	1
Enclosure	2	1
ETF-1100 Sensor Faucet	3A	4
Faucet Control Module	3B	4
ESD-1150 Sensor Soap Dispenser	4A	4
Soap Fill Port	4B	4
Fill Port Mounting Bracket	4C	
Soap Bracket	4D	4
Soap Reservoir	4E	4
Soap Pump	4F	4
EHD-1150 Dryer Spout	5A	4
Dryer Adaptor	5B	4
Hand Dryer Motor	5C	4