

REPLACEMENT PARTS

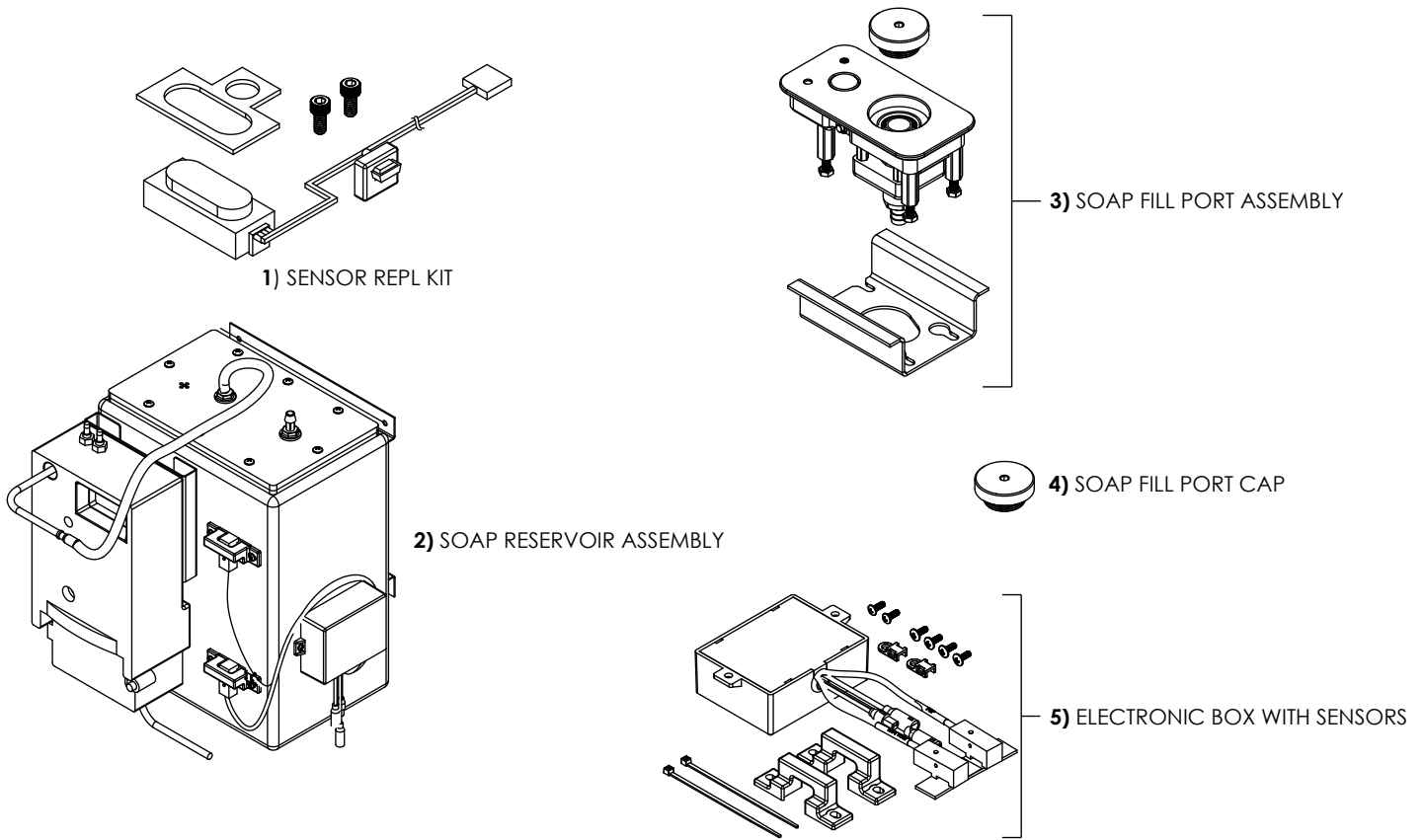

Item #	Code #	Description
1	33461057	Sensor Replacement Kit
2	63460148	Soap Reservoir Assembly
3	63460182	Soap Fill Port Assembly
4	33461092	Soap Fill Port Cap
5	33461093	Electronic Box with Sensors

EMERGENCY MEASURES

Take action according to the chemical being used as listed on the container. See the Safety Data Sheets.

Eye Contact: Flush eyes with water for a minimum of 15 minutes and consult a physician immediately.

Ingestion: Drink water to induce vomiting and consult a physician immediately.

Inhalation: Get fresh air immediately. If condition does not improve, consult a physician immediately.

If further assistance is required, please contact Sloan Tech Support at
1-888-SLOAN-14 (1-888-756-2614)