

# INSTALLATION INSTRUCTIONS FLITE-DEC SENSOR OPERATED, FOAM SOAP DISPENSER

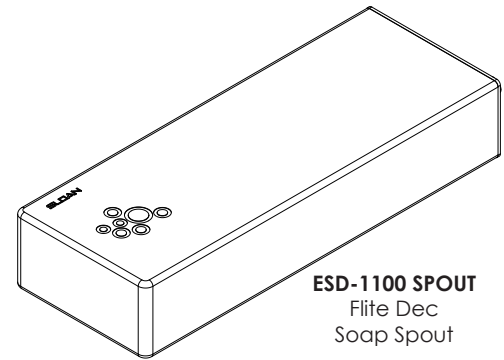

## Sloan® Limited Warranty Summary

Sloan Valve Company ("Sloan"), warrants its products against defects in materials and workmanship, excluding damage caused by matters beyond Sloan's reasonable control. Instructions for filing claims can be found in the Limited Warranty which can be obtained at [www.sloan.com](http://www.sloan.com) or by requesting a free copy by telephone at 888.756.2614. Sloan will repair or replace your defective product, or provide a refund, as your exclusive remedy. This is only a general summary of Sloan's Limited Warranty so it is important to note that the specific terms, conditions, limitations and exclusions, including the duration of warranty coverage for your particular Sloan product, are contained in the actual Sloan Limited Warranty. The Limited Warranty is subject to applicable laws in your country, state, province or other jurisdiction—and disputes arising under the Limited Warranty are to be resolved by binding arbitration unless you provide Sloan with an opt-out notice no later than 30 days after your purchase date. In case of a conflict with this summary, the terms and conditions set forth in the complete Limited Warranty will prevail.

## Important



Read this entire installation manual to ensure proper installation. When finished with the installation, file this manual with the owner or maintenance department. Compliance and conformity to local codes and ordinances is the responsibility of the installers.



Separate parts from packaging and make sure all parts are accounted for before discarding any packaging material. If any parts are missing, do not begin installation until all parts are obtained.



Make sure that all water supply lines have been flushed and completely turned off before starting the installation. Debris in supply lines can cause valves to malfunction.



Turn off electrical power to the electrical outlets, then unplug units prior to installation. Electrical power **MUST** remain off until installation is complete.



Wear all proper safety equipment prior to installation

## TOOLS REQUIRED FOR INSTALLATION

- Electric Drill
- 1/8" Drill Bit
- Phillips Head/Slotted Screwdriver
- Nut Driver or Deep Socket Set
- 7/16" Open Wrench
- Utility Knife
- Hammer
- 7/16" Socket
- Wire Stripper/Crimping Tool
- 3/16" Allen Key

## PRIOR TO INSTALLATION

An electrical outlet is needed for operation. It should be protected from any contact with water and be within the range of the power cord (approx. 70"). If no outlet is available, consult licensed electrician. (GFCI outlet suggested per code.)

Make sure that soap dispenser has sufficient space to not interfere with other components. Soap reservoir must sit flat on the ground.

### !!! IMPORTANT !!!

**THIS PRODUCT CONTAINS MECHANICAL AND/OR ELECTRICAL COMPONENTS THAT ARE SUBJECT TO NORMAL WEAR. THESE COMPONENTS SHOULD BE CHECKED ON A REGULAR BASIS AND REPLACED AS NEEDED TO MAINTAIN THE VALVES PERFORMANCE.**

If you have questions about how to install your hand dryer, consult your local Sloan Representative or call Sloan Technical Support at:  
**1-888-SLOAN-14 (1-888-756-2614)**

## INSTALLATION

Check that all parts are included in original packaging for proper installation.

### Package Contents:

Foam Soap Spout (1, Separate Package)  
Connector Case, Stainless Steel Pan Head (1)  
Spiral Cable Protector (1)  
Foam Pump (1)  
4 Screw Kit (1)  
Tube Clamp (2)  
Wire Guide Clip (2)  
Soap Reservoir Assembly (1)  
Reservoir Mounting Plates (1)  
Soap Fill Port (1, Separate Package)  
Bulk Fill Hose (1, Separate Package)

## CAUTION

Before using the dispenser, thoroughly read the "Precautions" attached to the liquid products. Immediately clean any spill on the floor to help avoid falling, injuries or other hazards.

## SPOUT INSTALLATION

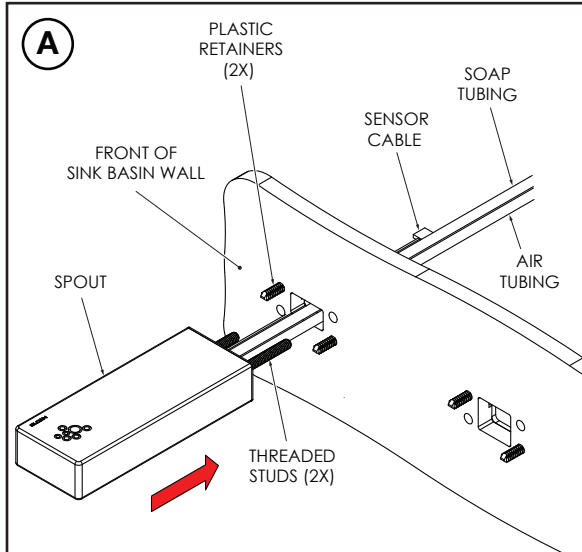

**A**

From lavatory/sink side, guide soap tubing, air tubing and sensor cable through the rectangular hole in the rear, basin wall. Guide the spout's threaded Studs through holes in the rear, basin wall.

**B**

Plastic retainers should fit into holes in the spout. Press Spout until it seats flat against the basin wall.

**C**

Attach the self-centering nuts (Qty. 2) to the threaded studs. **DO NOT** over-tighten nuts. Over-tightening may cause damage to the threads or surrounding parts.

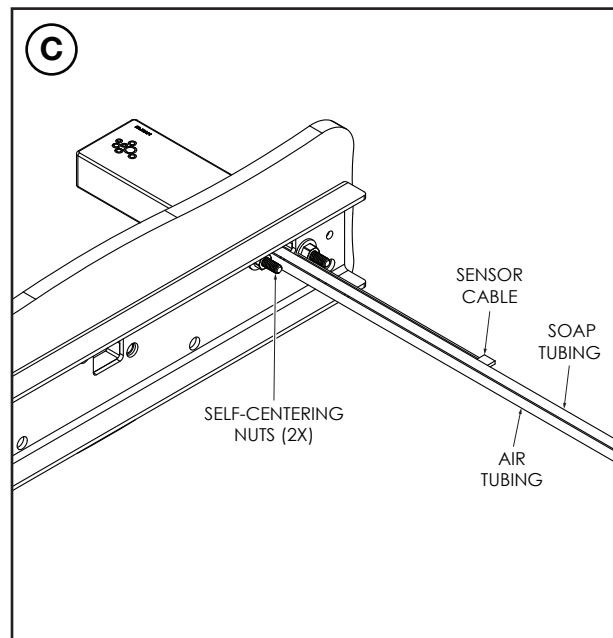
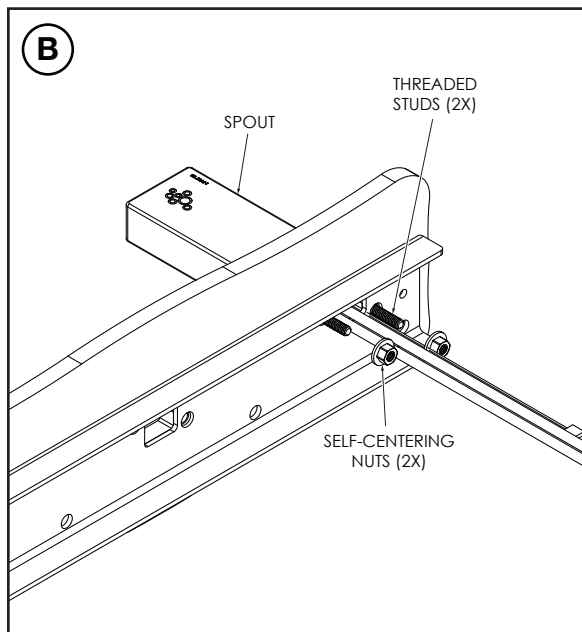

**FILL PORT INSTALLATION**

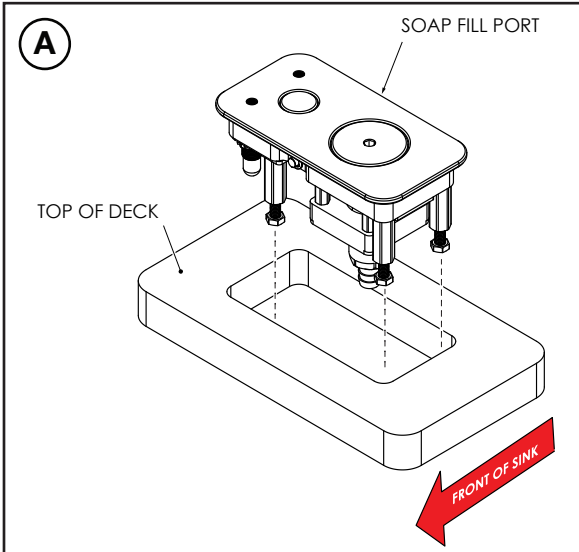

**A**

Install the soap fill port onto deck by aligning with cutout in deck. Make sure the black gasket is not pinched or twisted.

**B**

Loosen the four retaining bolts on the soap fill port. Do not remove the bolts. From the underside of deck, align the key slots in the mounting bracket with the four retaining bolts and slot into place.

**C**

Tighten the four retaining bolts to secure the mounting bracket to deck and the soap fill port.

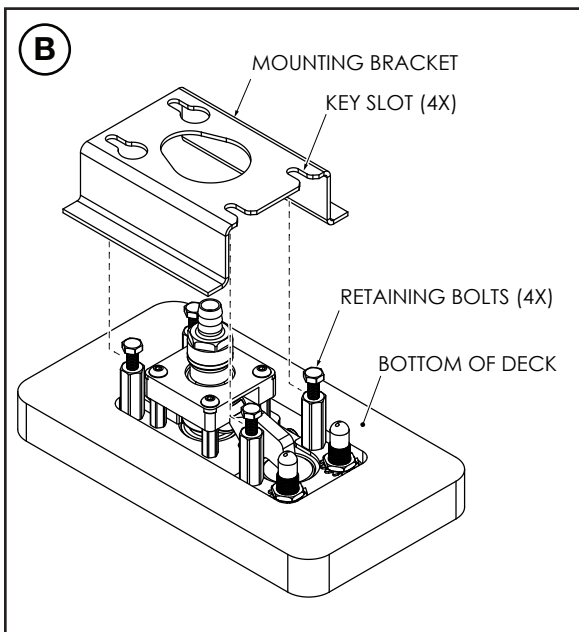

**C**

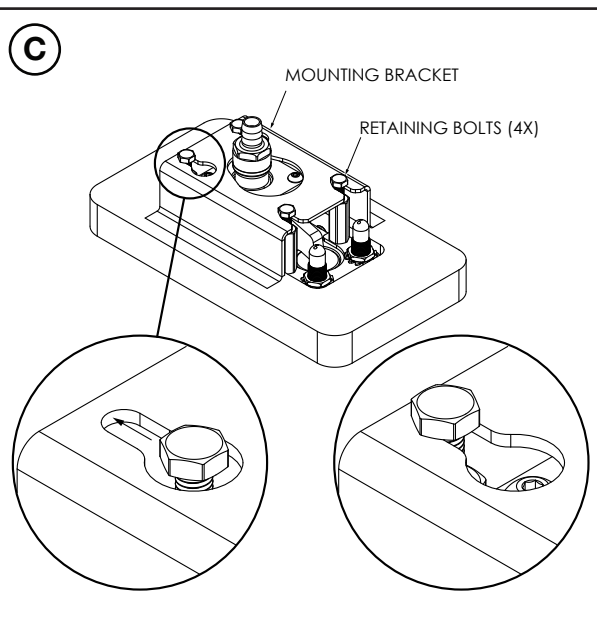

## SOAP RESERVOIR AND SOAP PUMP INSTALLATION

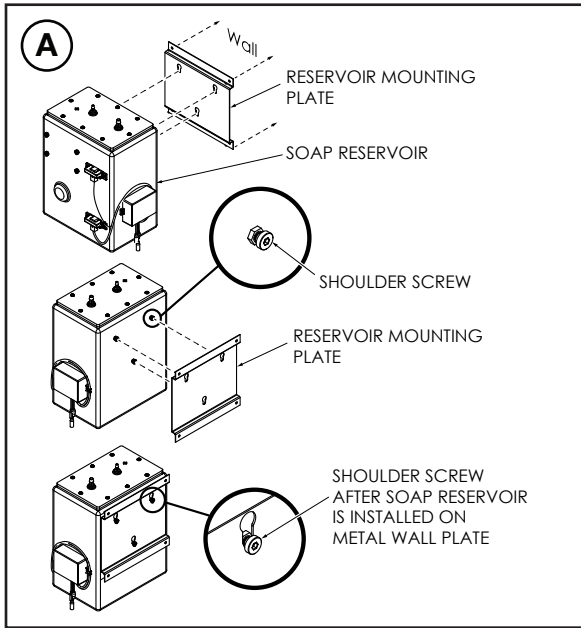

Mount reservoir mounting plate to the wall. (Hardware not provided)

**A**

- Mount the reservoir mounting plate onto the wall. (Hardware not provided)
- Align the 3 shoulder screws on the back of the soap reservoir with the key slots on the reservoir mounting plate and hang.
- Make sure the soap reservoir slides down onto the shoulder screws to secure.

Mount soap pump onto soap reservoir.

**B**

- Align the 4 key hole slots on the soap pump to the shoulder screws on the soap reservoir and hang.
- Make sure the soap pump slides down onto the on the shoulder screws to secure.

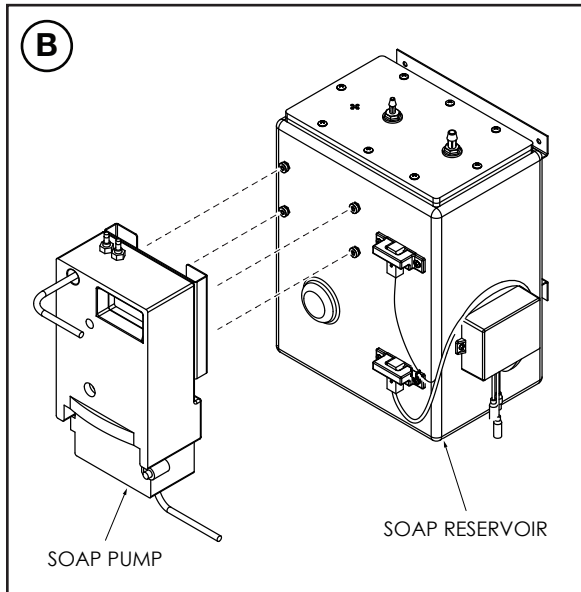

## CONNECT FOAM SOAP TUBE AND AIR TUBE

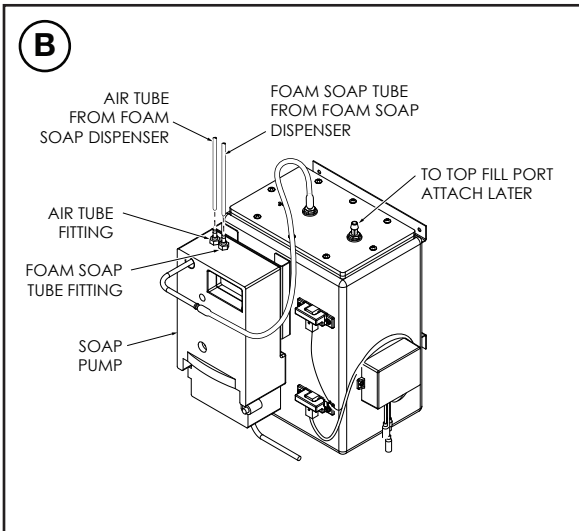
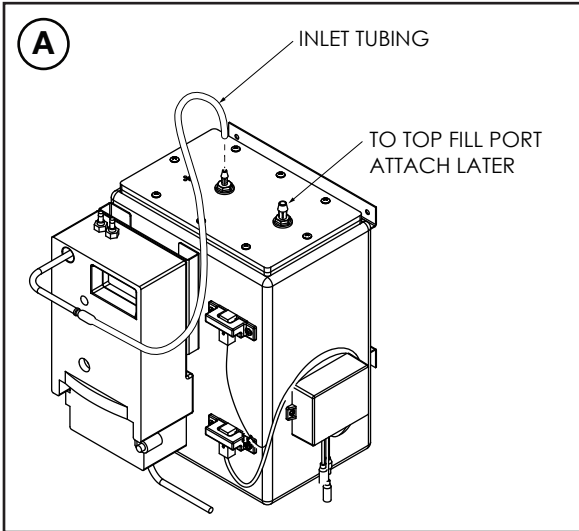

**A**

Attach the soap pump inlet tubing to the left, smaller, nipple on the top of the soap tank.

**B**

Slide a tube clamp onto the soap tubing and a clamp on the air tubing. Connect the soap tubing to the soap tube fitting. Connect the air tube to the air tube fitting. Make sure that the tubing is free of kinks or sharp bends. Secure both tubes by sliding the tube clamps down onto the fittings.

- Check soap tube tags and align with correct fittings as indicated on the fittings connection label.
- To help improve performance and avoid kinks in the hose, cut the soap tube and the air tube at suitable lengths. Ends should be cut at right angles and tubes should be free of kinks and bends when connected.
- Use the included spiral tube protector to keep the air and soap tubes together. Do not route the hand sensor harness in the spiral tube protector.

**Note:**

The soap pump must be primed/activated several times for soap to make its way to the user.

## LED AND POWER CONNECTIONS

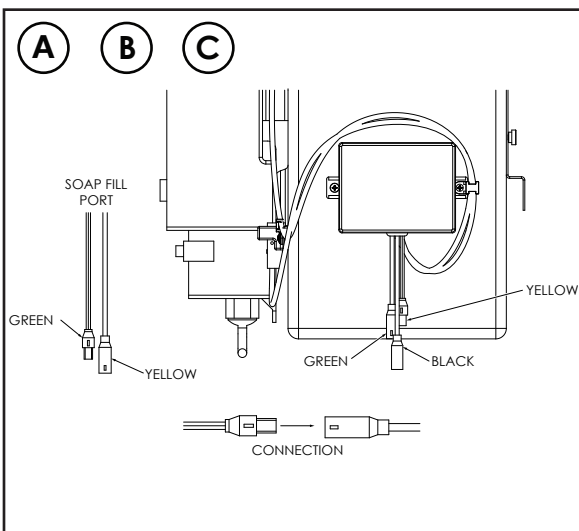

On the bottom of the soap reservoir assembly, there is an electrical box with three connectors: 1 Green, 1 Yellow, and 1 Black

**A**

Connect the yellow connector from the soap fill port to the yellow connector from the electrical box.

**B**

Connect the green connector from the soap fill port to the green connector from the electrical box.

**C**

Connect the black connector from the power supply to the black connector from the electrical box.

## CONNECT WIRING

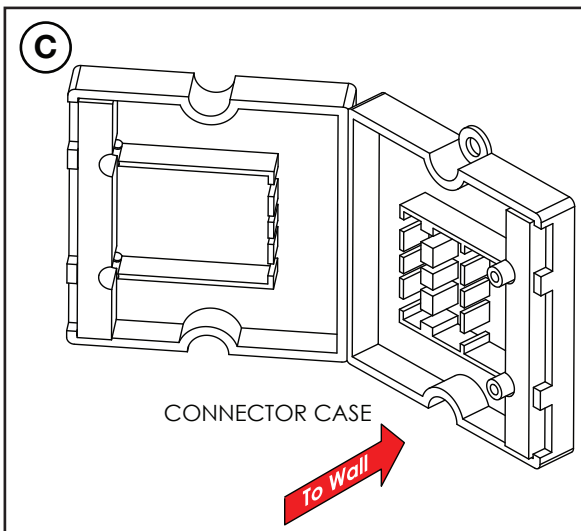
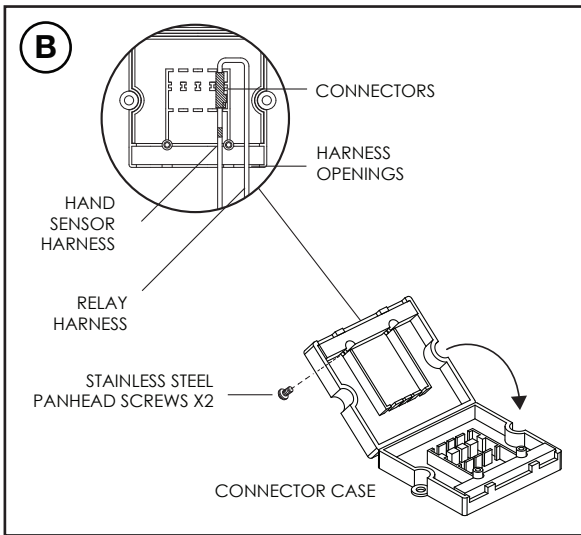
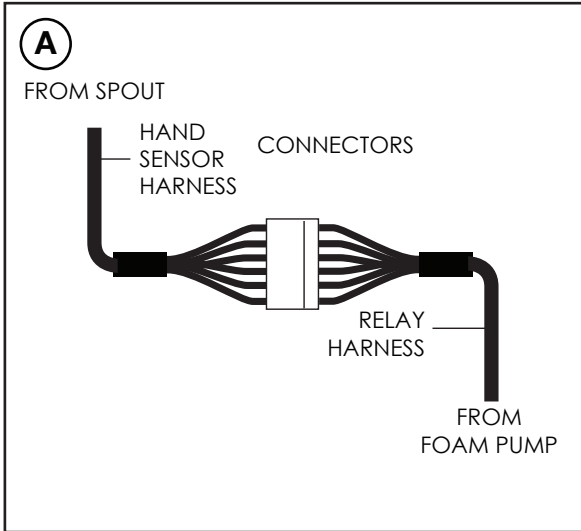

**A** Connect the hand sensor harness (from spout) to the relay harness (from soap pump).

**B** Feed the connectors of the relay harness and hand sensor harness into the connector case. The connectors sit vertically in the connector case as shown in the illustration. After positioning all wiring, fold down the connector case lid and lock it using the included stainless steel pan head screws.

- Be careful not to pinch the wiring in the connector case.

Completely clean an area in the chase where the connector case can be affixed.

- C**
- When mounting the connector case, screws must be accessible in case wiring needs accessing.
  - Harness openings must face down to keep water from entering case.

## Bulk Fill Hosing Connection

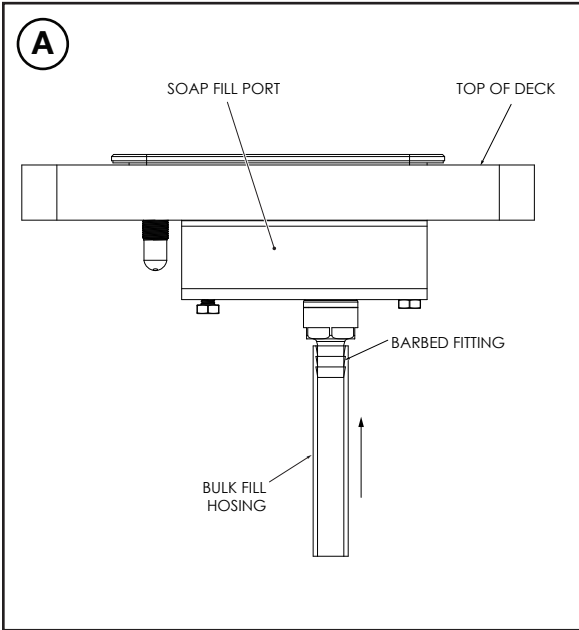

**A** Push bulk fill hosing over barbed fitting until flush with bottom of fitting.

**B** Push other end of bulk fill hosing over large barbed fitting on top of soap reservoir until flush with bottom of fitting.

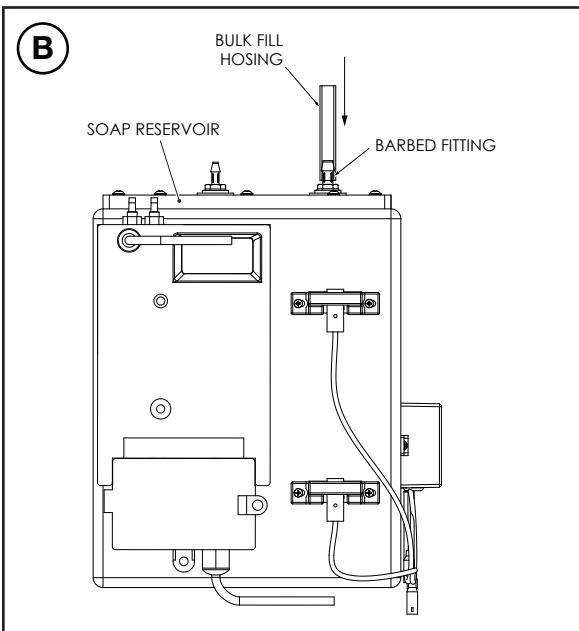

## Soap Fill/Refill Instructions

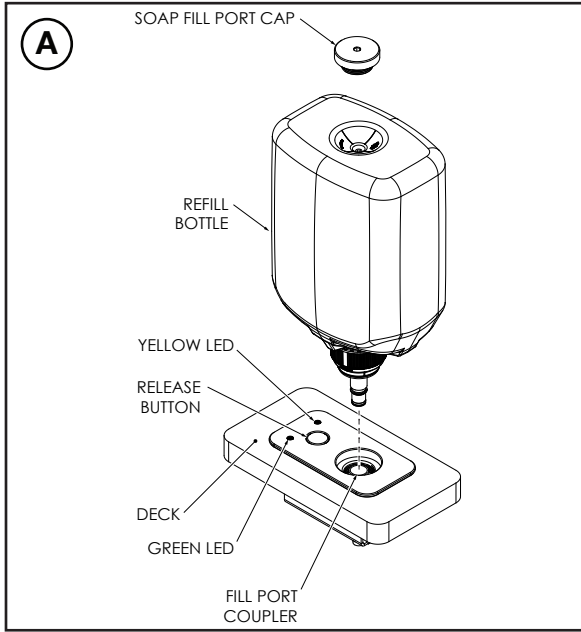

**A** Remove the fill port cap with a 3/16" allen key. Place the bottle in the soap port and lightly press down until you hear a click. The soap bottle is locked into place and will begin filling/refilling the soap reservoir. **DO NOT SQUEEZE THE BOTTLE, DOING SO MAY CAUSE OVER FILLING THE SOAP RESERVOIR.**

**B** Stop filling the Soap Reservoir when the green LED illuminates. This indicates that the reservoir is full. Once the green LED is illuminated, finish emptying the current bottle. Press the release button to remove the soap fill bottle and attach the fill port cap.

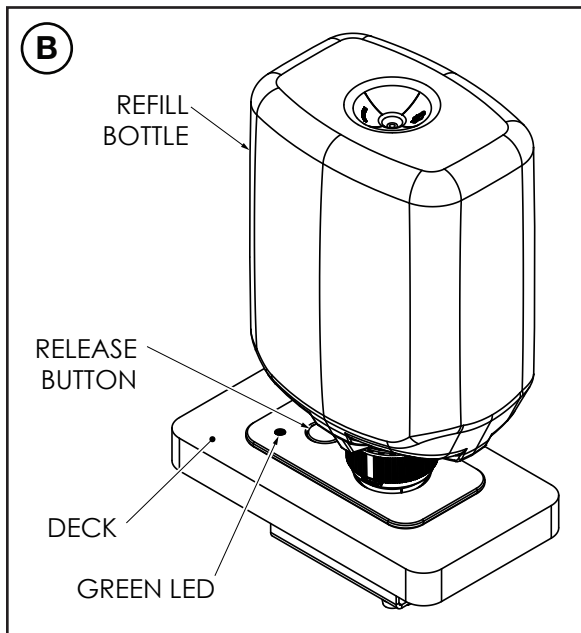

| LED Color | Indication                                 | Action  |
|-----------|--|---|
| Green     | Soap Reservoir is Full                     | Stop filling the soap reservoir. Remove soap refill bottle. Do not add any more soap once LED is green.   |
| No LED    | Soap Reservoir is between 20% and 80% full | No Action Required. Do not add any soap if no LED indicator.  |
| Yellow    | Soap Reservoir is less than 20% full.      | Soap reservoir needs to be refilled. Follow the above steps to properly refill the soap reservoir. Add up to four (4) bottles of soap, but no more. |

## CLEANING THE HAND SENSOR

Clean the hand sensor periodically (about once a month) according to the following procedure:

- On the soap pump, press the button marked Operation Switch once. The operation light will turn off
- Gently wipe the hand sensor area with a cloth moistened with warm water.
- Press the operation button again. (the operation light will turn back on).
- Make sure that the nozzles properly dispenses foam soap.

**NOTE:** Do not leave water drops on the hand sensor area. Remaining water drops may cause a malfunction.

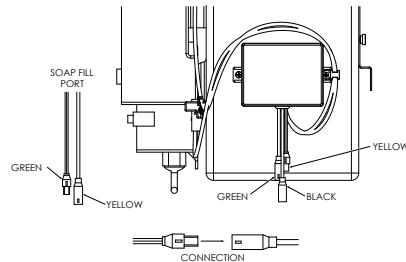

## CLEANING FOAM SOAP DISPENSER

If the tip of the soap nozzle is clogged, the dispensing capability may fail or function partially. Clean the nozzle according to the following procedure:

- On the soap pump, press the button marked Operation Switch once. (The operation light will turn off)
- Remove the spout face plate by removing the two flat head screws with a 5/64" allen key. Remove the internal gasket covering the nozzle and sensor and set it temporarily aside.
- Remove the two internal screws with a 7/64" allen key.
- Lift out the nozzle and attached tubing. Remove the screw holding the nozzle to the attached tubing.
- Pull out the mesh filter between the nozzle and attached tubing. Rinse the mesh filter and nozzle with lukewarm water.
- Re-insert all parts back to their previous location.
- Press the operation button again. (the operation light will turn back on)
- Check that the foam soap properly dispenses.
- Repeat as needed.

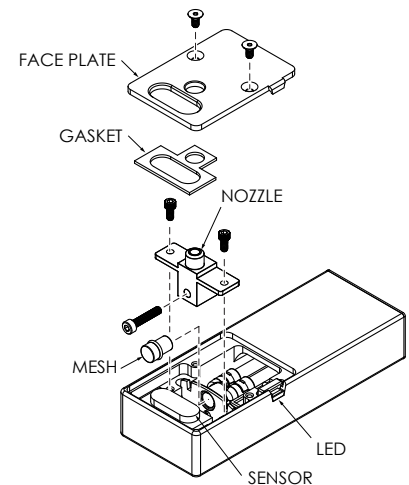

## BEFORE CALLING FOR REPAIR

| Problem                               | Action  |
|---------------------------------------|---|
| Unit does not operate.                | Check operation switch is on.<br>Check power plug is securely inserted to the outlet.           |
| Soap does not dispense.               | Soap reservoir needs refilling.<br>Check soap dispensing nozzle for clog.<br>Clean hand sensor. |
| Liquid soap is not in foam state.     | Check mesh is mounted in the foam-dispensing nozzle.  |
| LED blinking RED, no soap dispensing. | Refill soap reservoir as needed. See page 7 for replacement soap.                               |

## REPLACEMENT PARTS

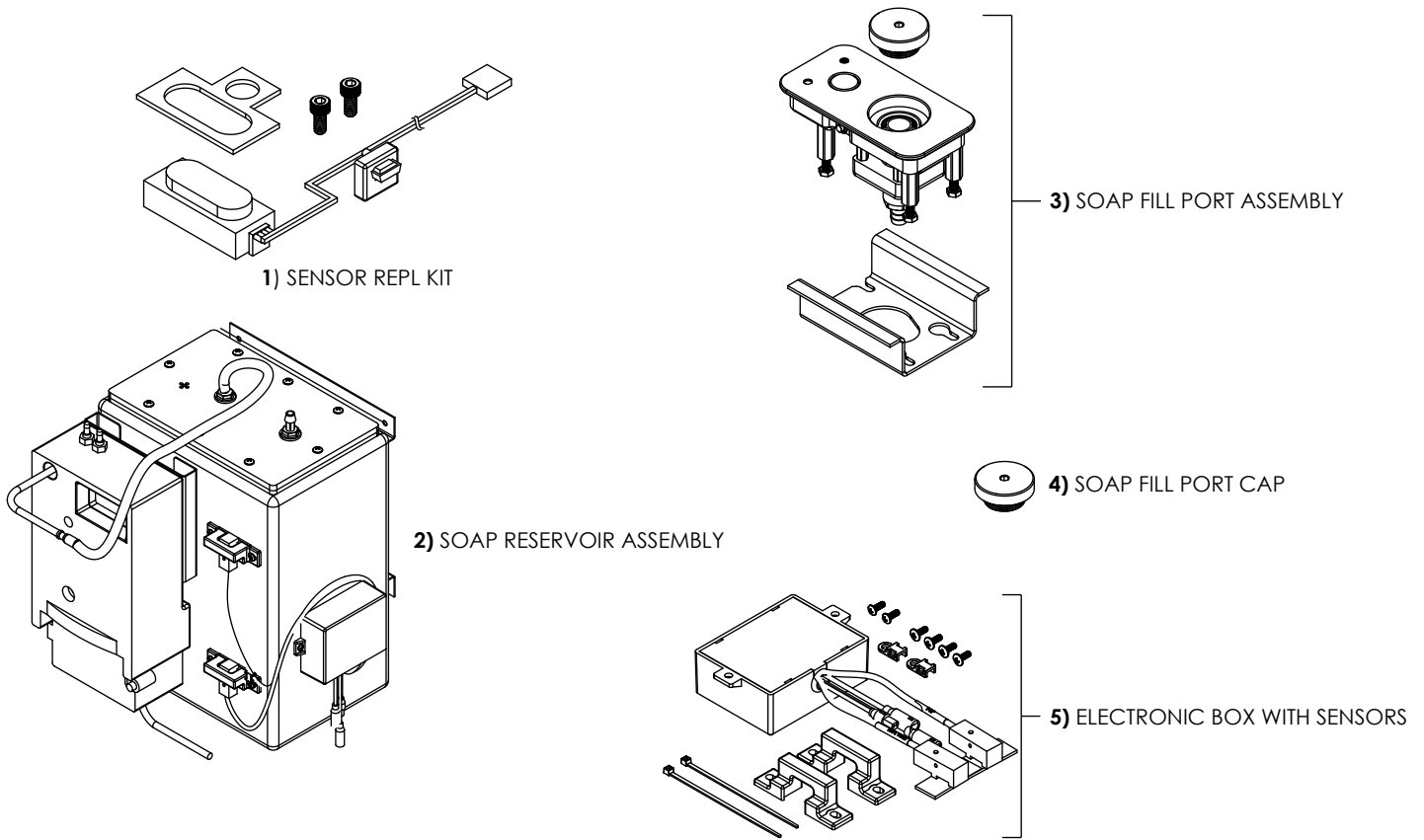

| Item # | Code #   | Description                 |
|--------|----------|-----------------------------|
| 1      | 33461057 | Sensor Replacement Kit      |
| 2      | 63460148 | Soap Reservoir Assembly     |
| 3      | 63460182 | Soap Fill Port Assembly     |
| 4      | 33461092 | Soap Fill Port Cap          |
| 5      | 33461093 | Electronic Box with Sensors |

## EMERGENCY MEASURES

Take action according to the chemical being used as listed on the container. See the Safety Data Sheets.

**Eye Contact:** Flush eyes with water for a minimum of 15 minutes and consult a physician immediately.

**Ingestion:** Drink water to induce vomiting and consult a physician immediately.

**Inhalation:** Get fresh air immediately. If condition does not improve, consult a physician immediately.

If further assistance is required, please contact Sloan Tech Support at  
1-888-SLOAN-14 (1-888-756-2614)